

CW ROTATION

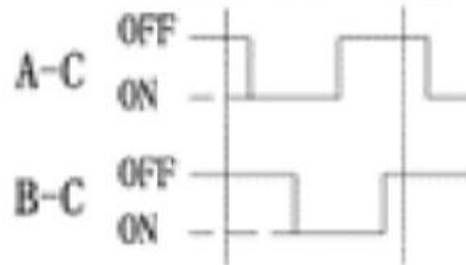

P.C.B Mounting Detail
Viewed From Mounting Side

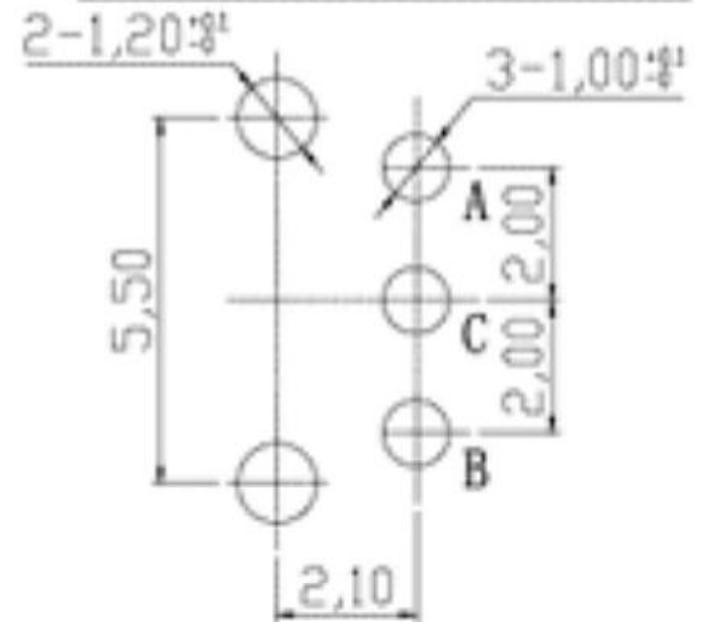

SPECIFICATIONS

1. Rating : DC 10V , 1 mA Max ;
2. Circuit : 1C - 1P ;
3. Operating force : 25 ±10 gf ;
4. Contact resistance : 100 mΩ Max ;
5. Travel : 0.25 ± 0.1 mm ;
6. Life : 150,000 Cycles Min .
(each upright and opposite roate)



东莞市高迪电子有限公司

Dong Guan KDRR Electronic Switch Jack Co., Ltd.

TOLERANCE UNLESS
OTHERWISE STATED :

Up to 5 ±0.2
Above 5 - 15 ±0.3
Above 15 - 30 ±0.4
Above 30 - 50 ±0.5
Angle ±0.3

3RD.
ANGEL'S



UNITS

MM

DRAWN BY:	DATE
Frank Wu	10/17/11
CHECKED BY:	DATE
Jacky Chen	10/17/11
APPROVED BY:	DATE
Tony Kao	10/17/11

MAT'L		TITLE	ENCODER
FINISH		MODLE	ENCODER
SCALE	1 : 1	DWG NO.	K50-A
SHEET NO.	1 of 1	PART NO.	K50-A
		SIZE	A4
		VER	A

ITEM NO.	DESCRIPTION	DRAWN	DATE
----------	-------------	-------	------